

白云鄂博矿区16#街坊

危房改造项目



2025.06

加固设计说明

- 1、加固材料：H型钢 HW200×204×12×12
- 2、立柱详图 HW200×204×12×12
- ①高度随户型待定。
- ②立柱基：C30、内配三级钢筋直径16@200双层双向钢筋网片。

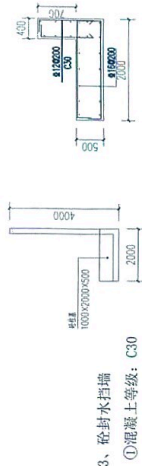

- 3、砼封水挡墙
- ①混凝土等级：C30
- ②间隔500mm在后墙植直径12（三级钢）钢筋连接原墙体，长度500mm，梅花式布置。

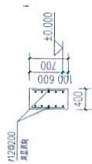

- 4、斜拉柱基B×L×H=1000×1000×1000
- ①混凝土等级：C30
- ②上下配置直径16（三级钢）钢筋间距200mm，双层双向钢筋网片，下层网片与H型钢焊接。

- 5、H型钢加固处理：
- ①横竖呈方格布置。
- ②H型钢内填充岩棉板，外侧三面挂尼龙网格布，刮腻子做真石漆面层，拟和原墙项目，或按甲方要求。



- 6、本方案优点
- ①不占用居民生活通道，墙面造型美观。
- ②保证原有墙体不再发生变形。
- ③整体保护原有基础不再进水泡。

方案一

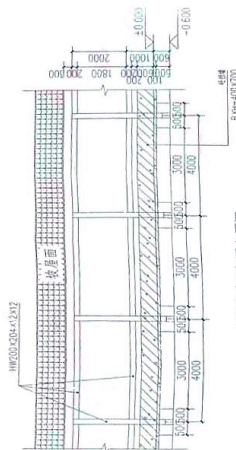

后墙H型钢加固立面图

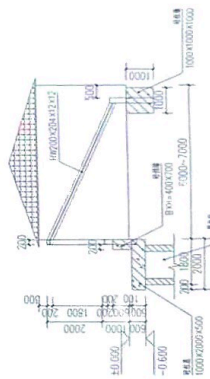

山墙H型钢加固立面图

方案二

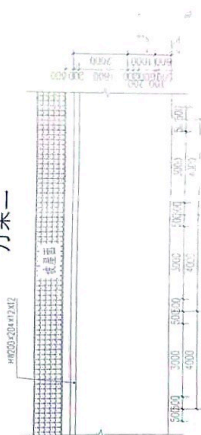

前墙H型钢加固立面图

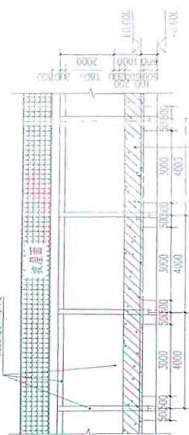

后墙H型钢加固立面图

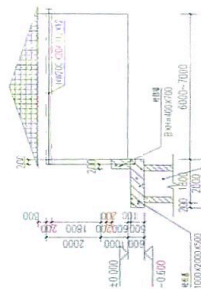

山墙H型钢加固立面图



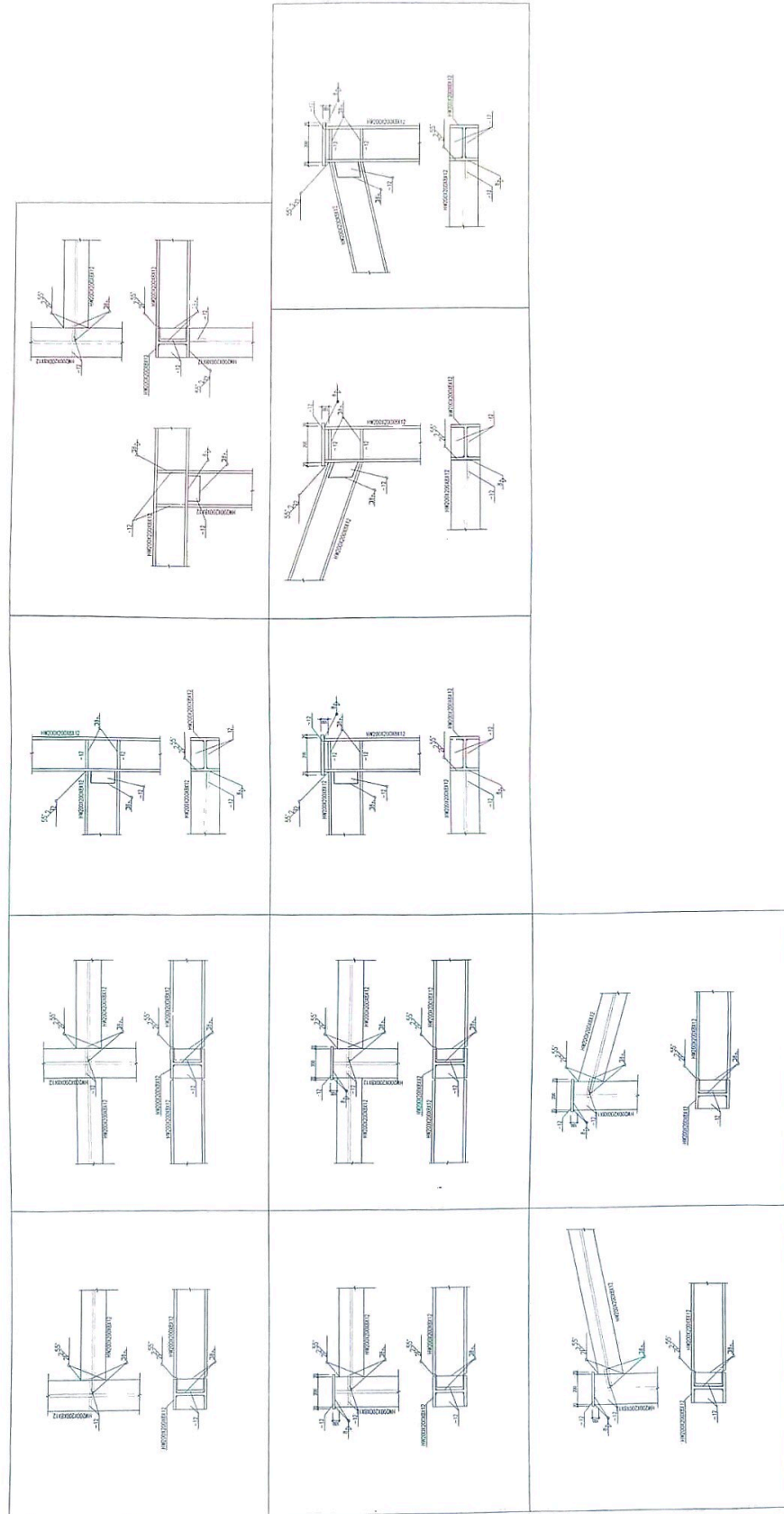

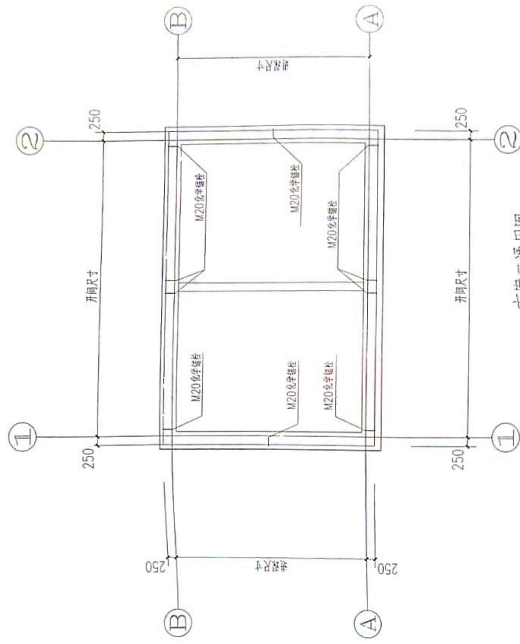

方案二通用图

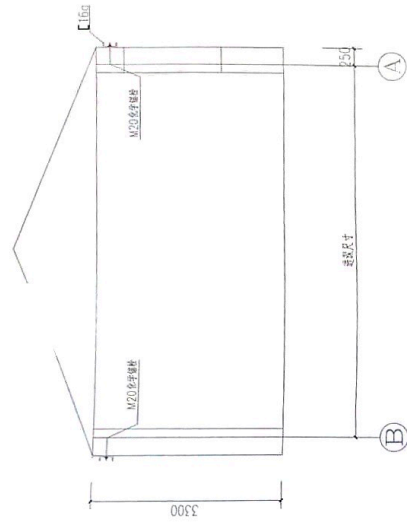

0-0

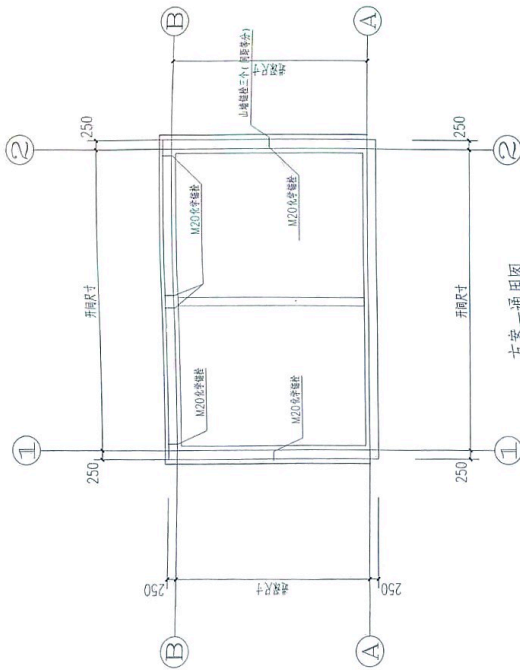

方案一通用图

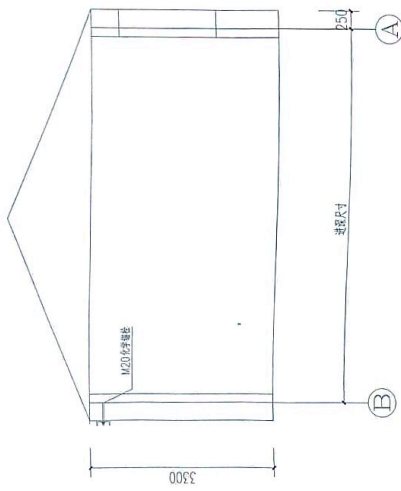

0-0

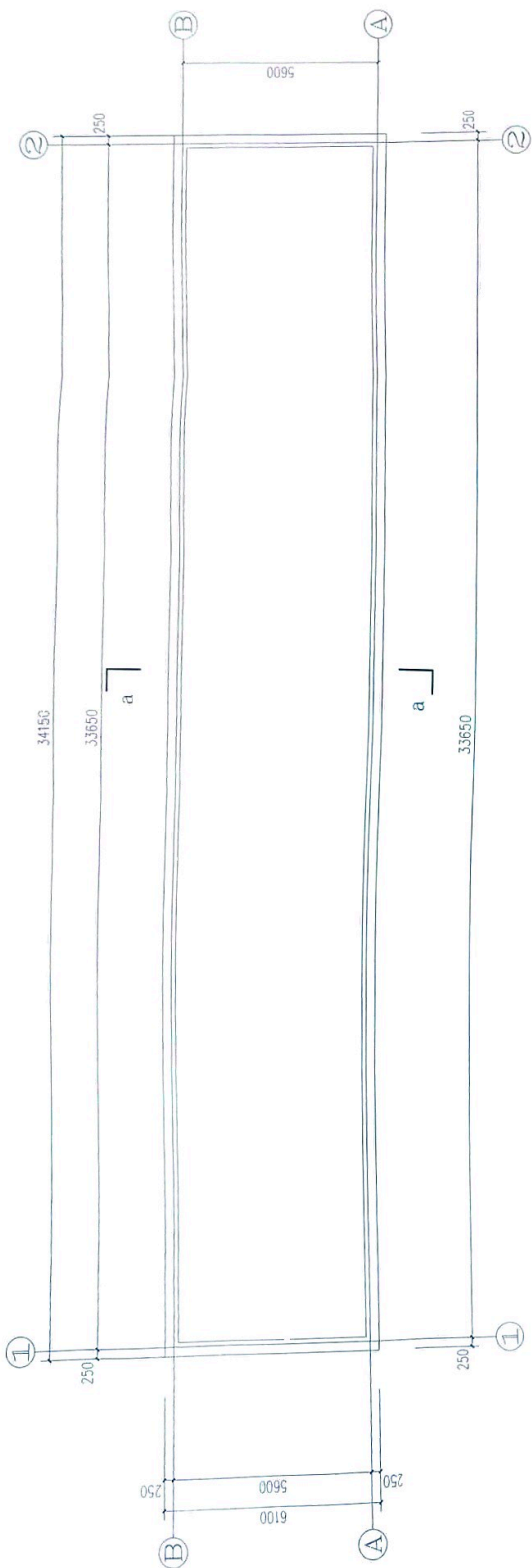

建筑平面布置图 1:100

9栋

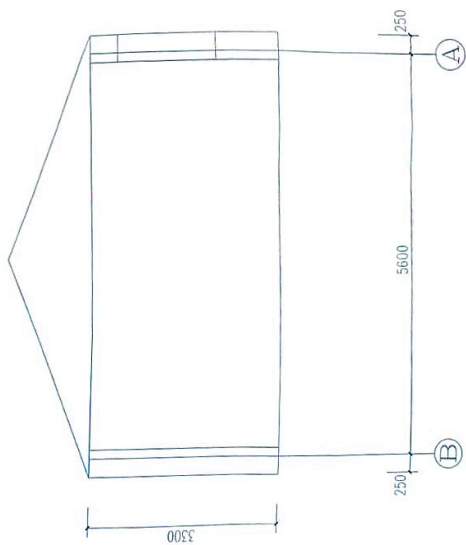

Q-Q

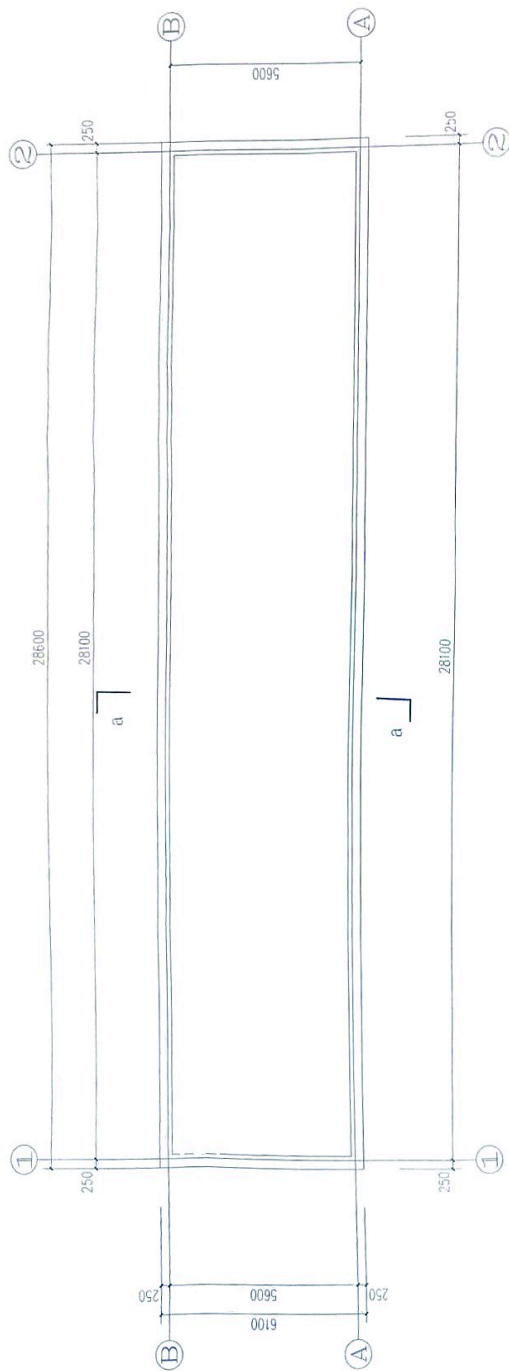

建筑平面布置图 1:100
11栋

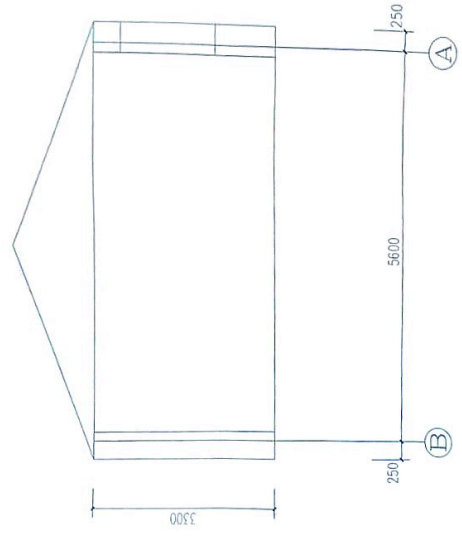

0-0

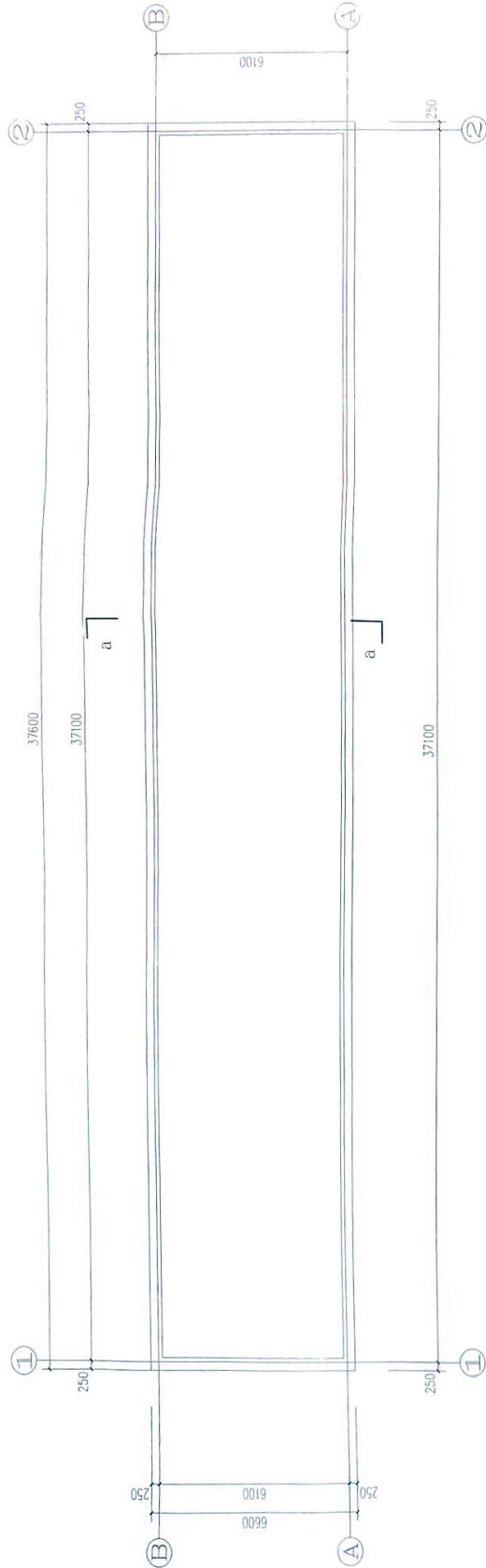

建筑平面布置图 1:100

14栋

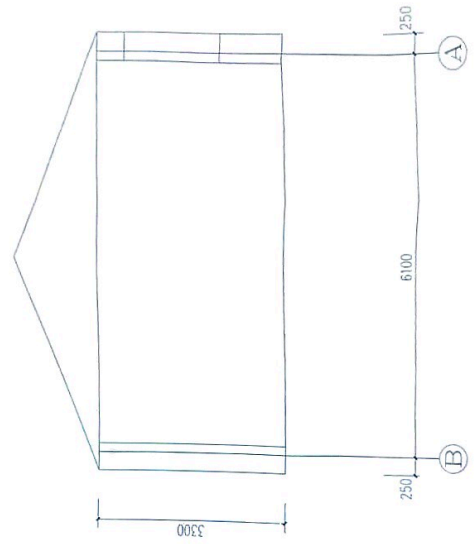

0-0

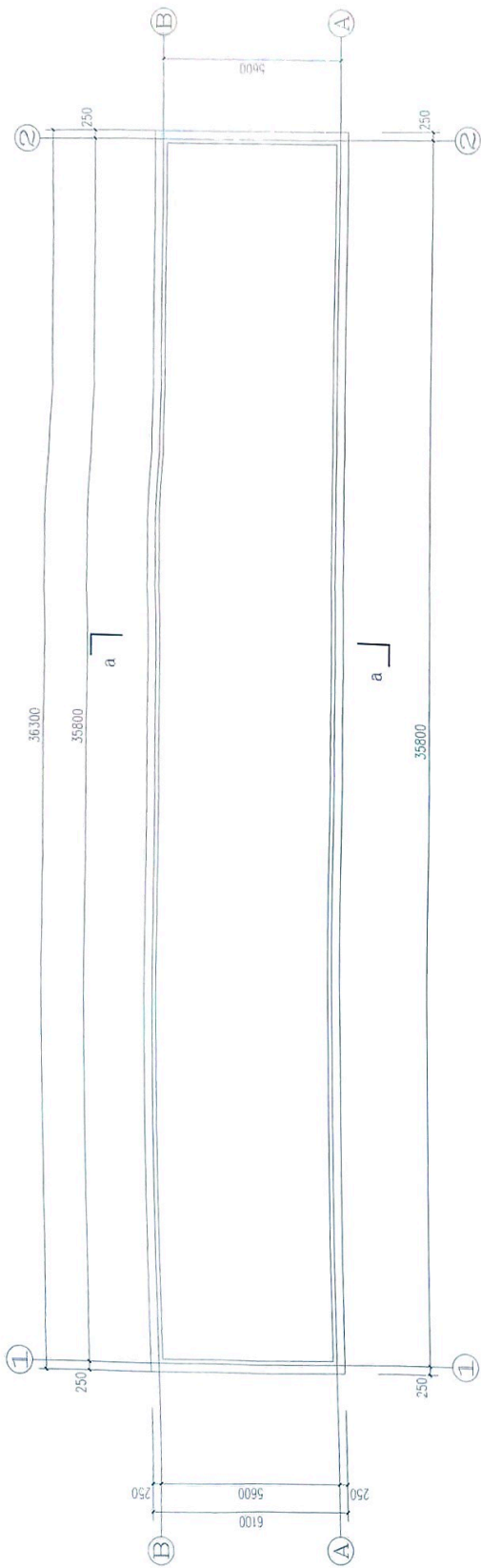

建筑平面布置图 1:100
19栋

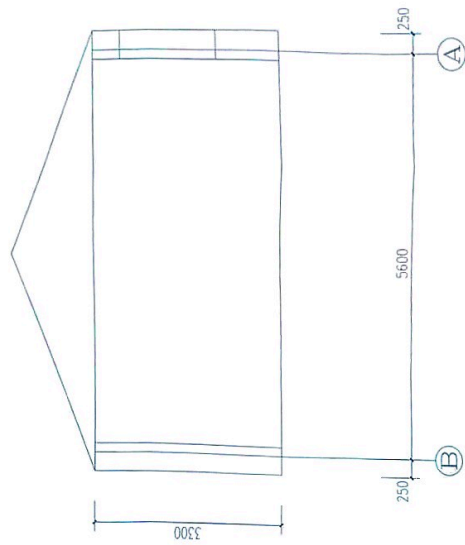

D-D



建筑平面布置图 1:100
20栋

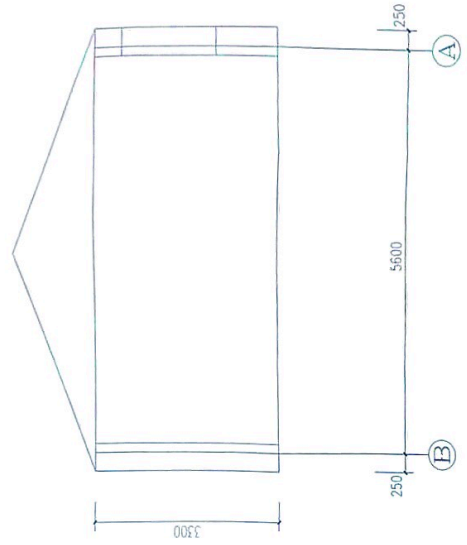

0-0

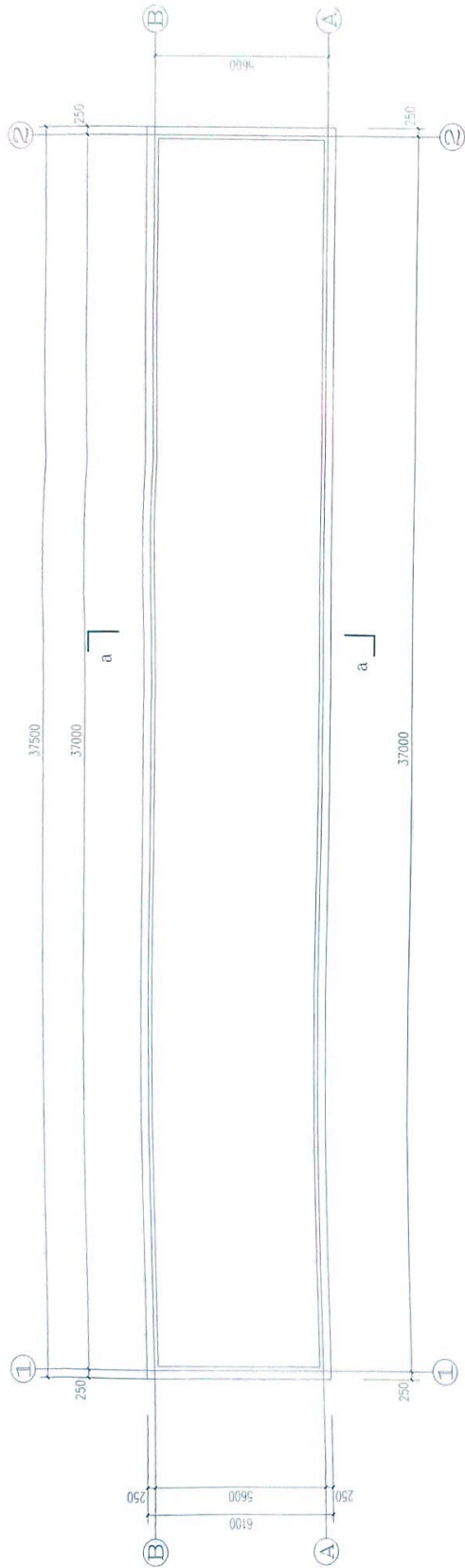

建筑平面布置图 1:100

22、23栋

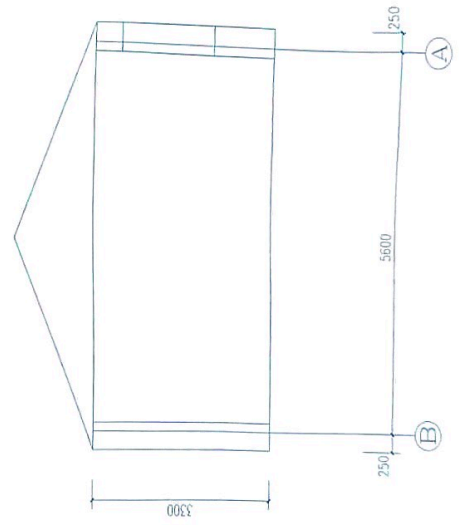

A-A

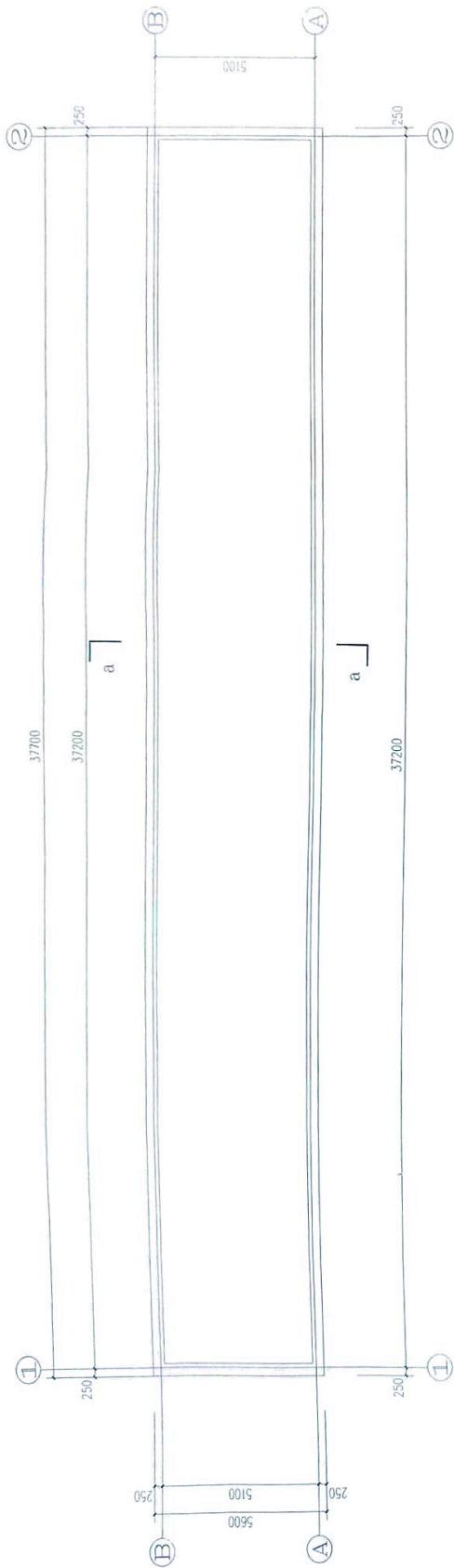

建筑平面布置图 1:100

24栋

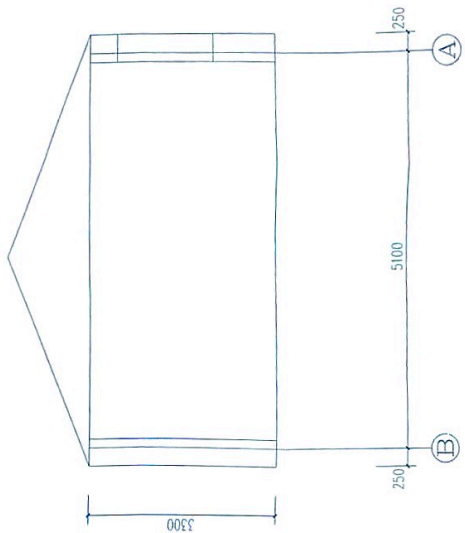



建筑平面布置图 1:100
25栋

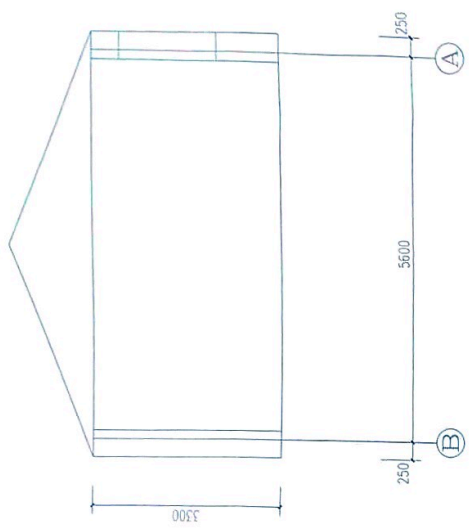

D-D

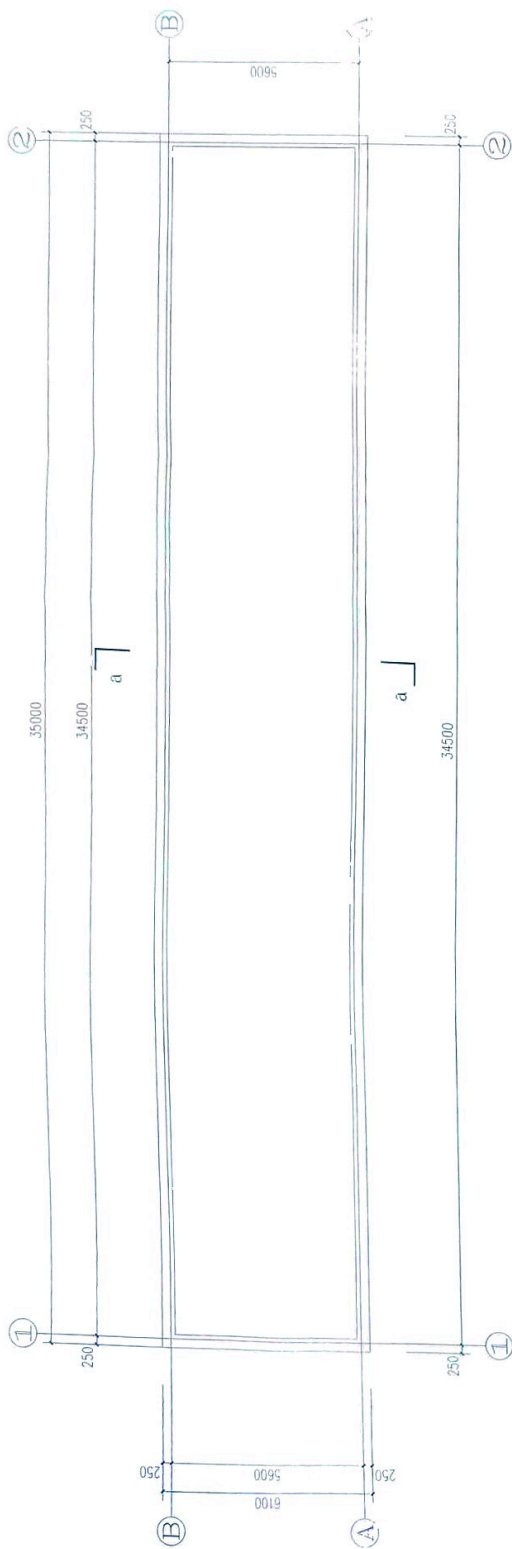

建筑平面布置图 1:100
27、30、39、43、44栋

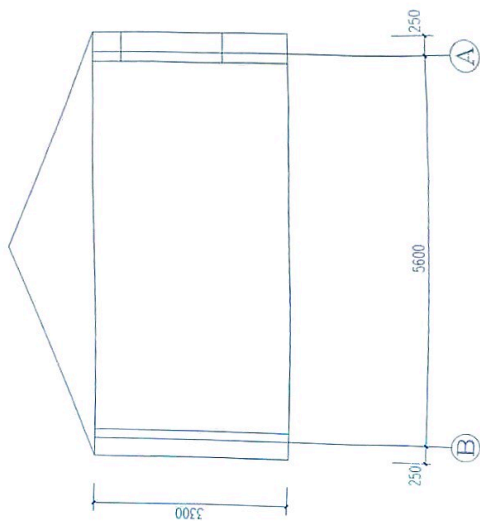

0-0

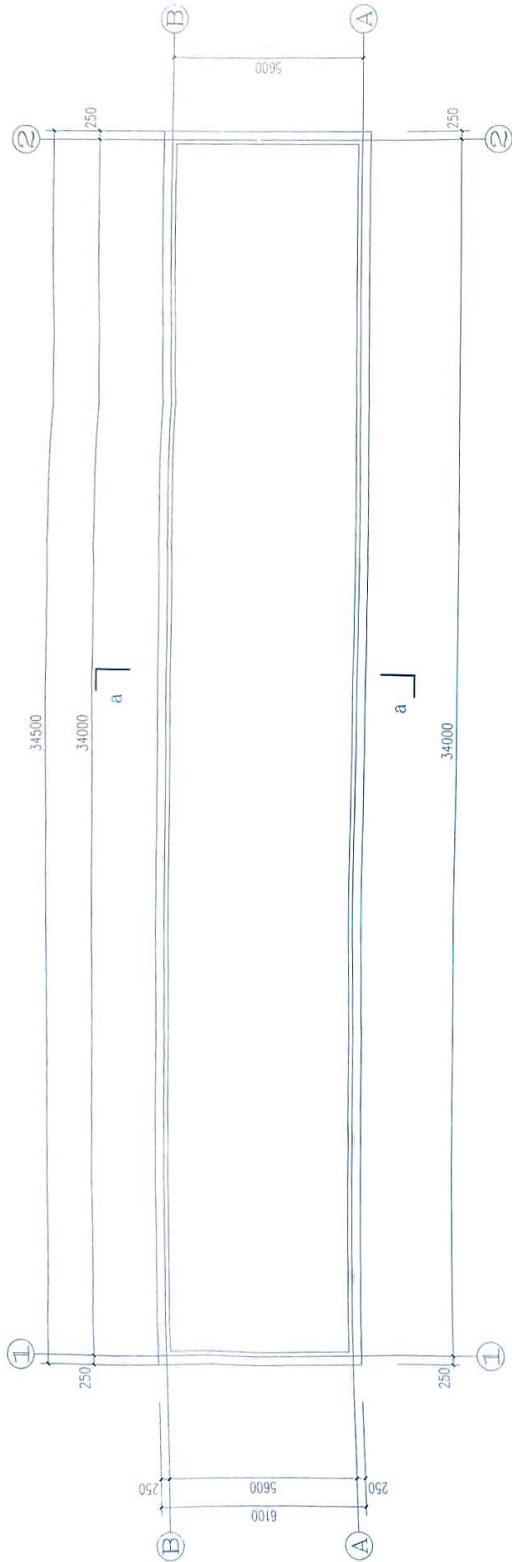

建筑平面布置图 1:100

33, 34栋

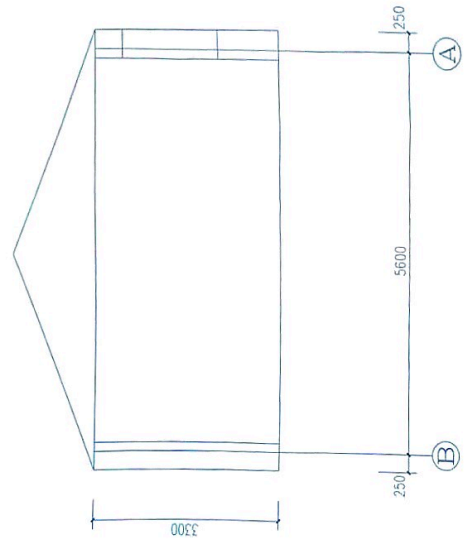

A-A

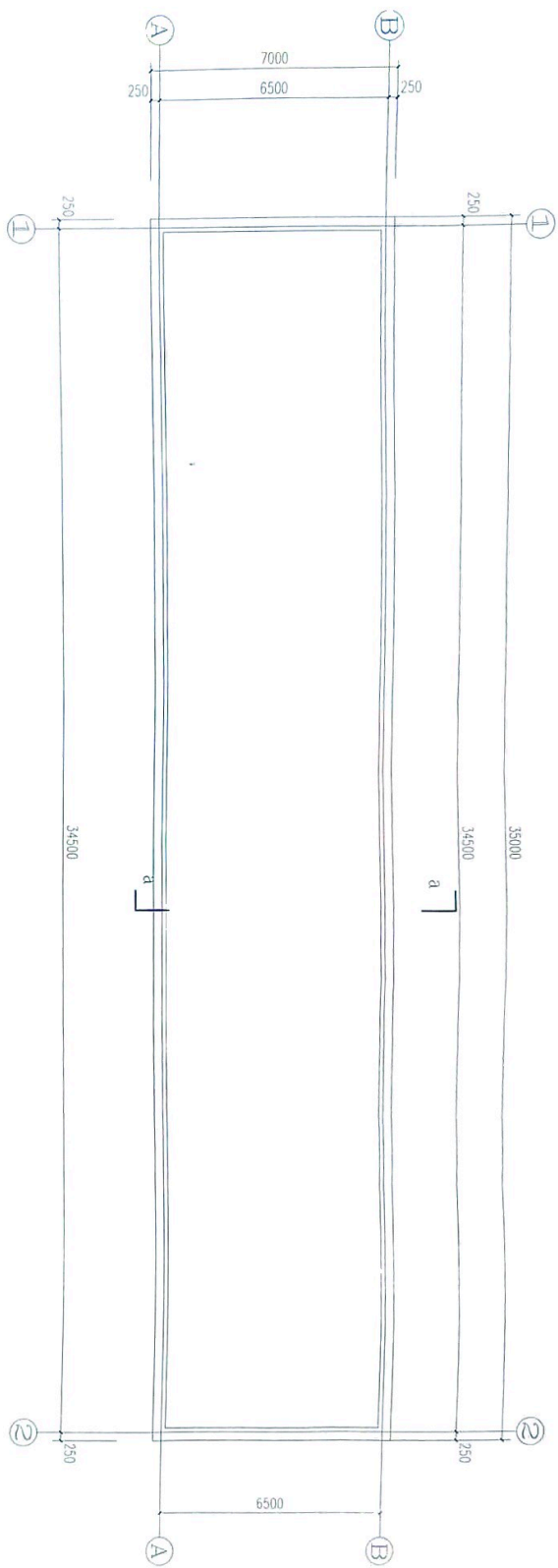

建筑平面图 1:100
36栋

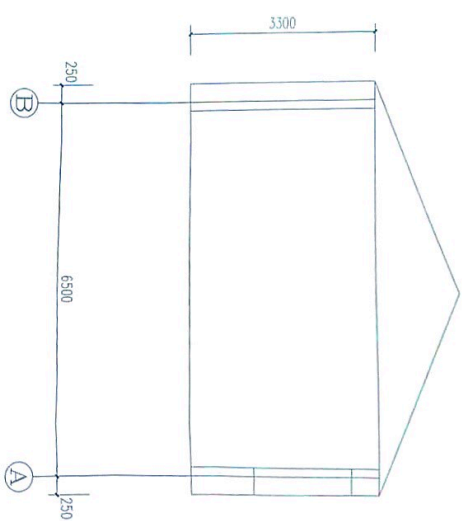

0-0



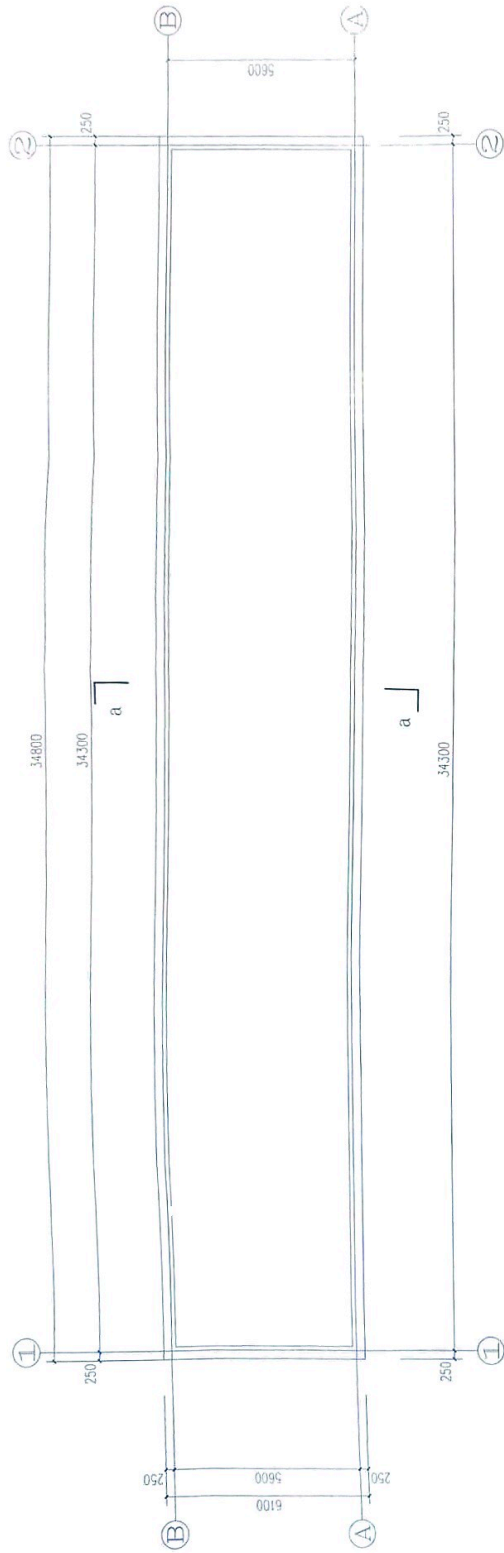

建筑平面布置图 1:100
40 栋

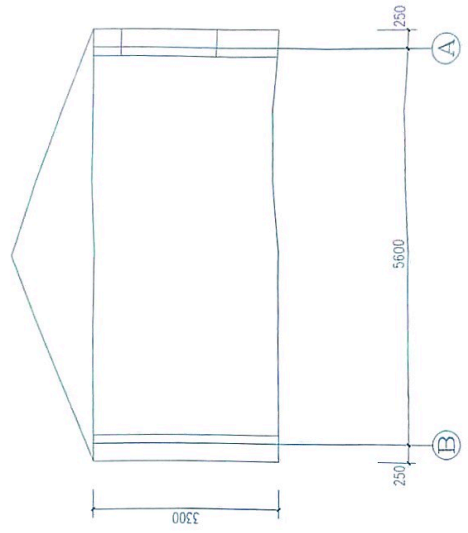

C-C

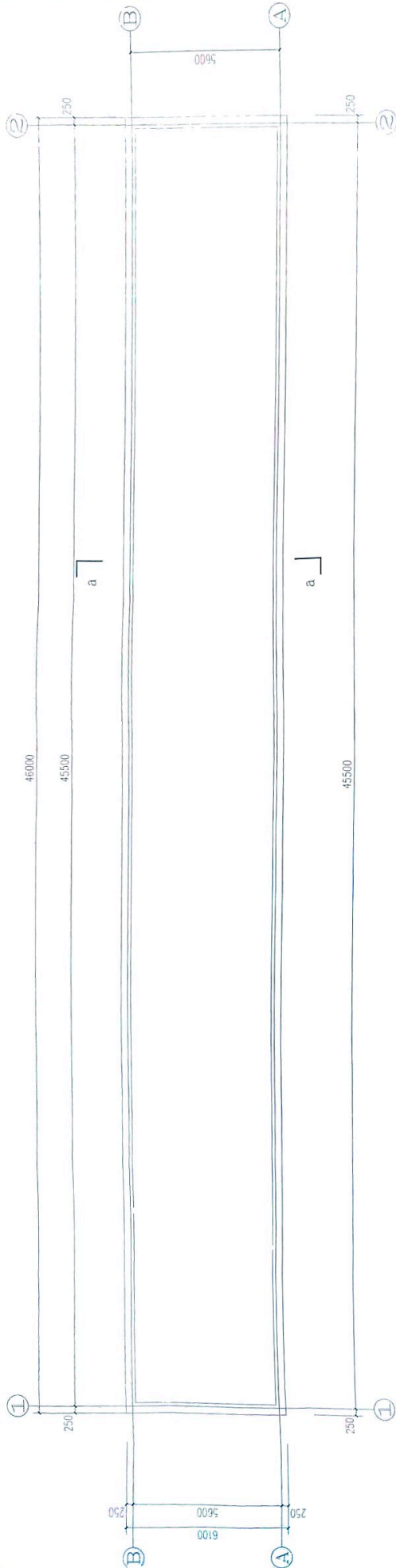

建筑平面布置图 1:100

45栋

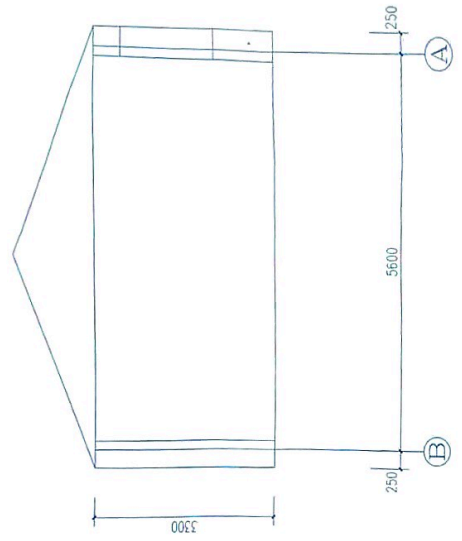

0-0

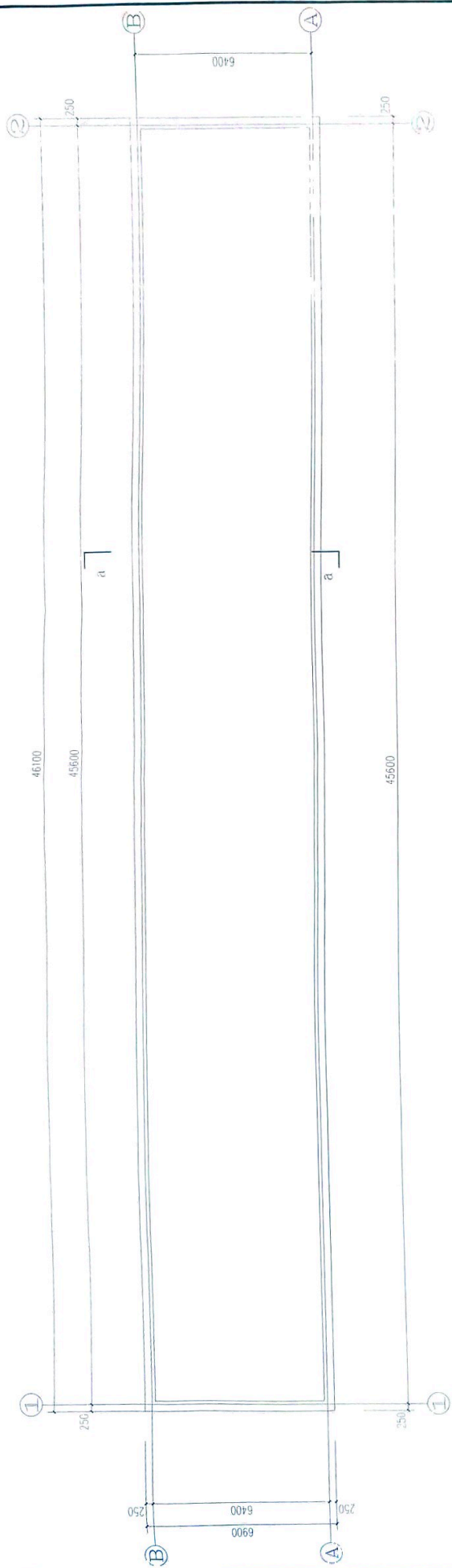

建筑平面布置图 1:100
50栋

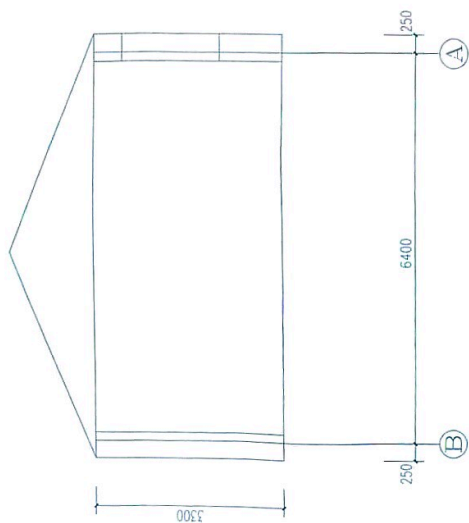

D-D